

AMER SPEC INC

COMMERCIAL BATHROOM ACCESSORIES

DUAL ROLL TOILET TISSUE DISPENSER

Special Order

Surface Mounted
Stainless Steel

Holds two rolls up to 5-1/4" dia. Stainless Steel cabinet. Theft resistant spindles.

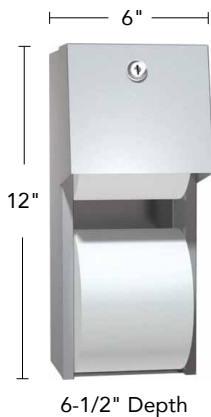

<u>Code</u>	<u>Description</u>	<u>List/ea</u>
0030*	Tissue Dispenser	\$ 86.00

SINGLE TOILET TISSUE HOLDER

Special Order

Surface Mounted
Chrome Plated Steel.
With vandal resistant locking device.

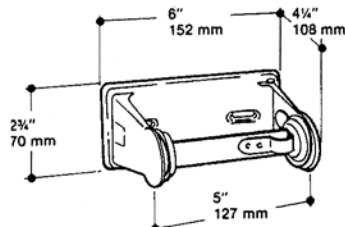

<u>Code</u>	<u>Description</u>	<u>List/ea</u>
0710*	Single Roll Holder	\$ 11.03

DOUBLE TOILET TISSUE HOLDER

Special Order



Surface mounted. Plated steel with a bright chrome finish. Heavy duty brake springs provide controlled delivery. Vandal resistant locking device.
Overall: 12-3/8" L x 2-3/4" H x 4-1/4" D

<u>Code</u>	<u>Description</u>	<u>List/ea</u>
0715*	Double Roll Holder	\$ 18.38

STAINLESS STEEL CHANNEL FRAMED MIRROR

Special Order

0620 - Without Shelf
0625 - With Shelf

Both mirrors have a glass mirror surrounded by a 20 gauge stainless steel frame.



The #0625 has an 18 gauge stainless steel 5" wide shelf and is supplied with mounting brackets.

<u>Code</u>	<u>Size</u>	<u>List/ea</u>
0620-1620*	16" W x 20" H	\$ 81.00
0620-1624*	16" W x 24" H	73.00
0625-1624*	16" W x 24" H w/ shelf	148.00

BOMMER COAT & HAT HOOK WITH DOOR STOP

Proj: 3-3/4". Wrought brass hook with dull chrome finish. 1/box.



<u>Code</u>	<u>Size</u>	<u>List/ea</u>
5030-626	Bright Chrome	\$ 60.37

COMMERCIAL BATHROOM ACCESSORIES

AMER SPEC INC

SOAP DISPENSERS

Special Order



0345



0347

Stainless Steel, #4 satin finish. All purpose soap valve and unbreakable refill window. Concealed fastening and hinged filler-top. Capacity: 40 fluid ounces (1.2 L).

0345 Horizontal Soap Dispenser

Overall size: 8-1/8" W x 4-3/4" H x 4" projection.

0347 Vertical Soap Dispenser

Overall size: 4-3/4" W x 8-1/8" x 5-1/4" projection.

<u>Code</u>	<u>Description</u>	<u>List/ea</u>
0345*	Horizontal Soap Dispenser	\$ 45.89
0347*	Vertical Soap Dispenser	50.47

AUTOMATIC FOAM SOAP DISPENSER

Special Order

A foam drop is dispensed out of the nozzle on unit bottom each time its battery-operated sensor is activated. Capacity: 34 oz. (1000 ml) of liquid foaming soaps within a wide range of viscosity.



20365

5 1/2" x 10 7/8" x 4" projection.

<u>Code</u>	<u>Description</u>	<u>List/ea</u>
20365*	Foam Soap Dispenser	\$ 235.00

TRI-Umph™ HIGH-SPEED HAND DRYER

Special Order

Overall Size

12-43/64" W x 23-1/8" H x 7-3/4" D



20200

- Quick drying — about 12 seconds
- Ergonomic — No need to bend over or bend knees
- Air blows down and back from vents on three sides
- No water splash-back: water from hands is pushed backwards onto absorbent ceramic plate...not the floor
- Ultra hygienic — Over 99% of airborne bacteria is eliminated with the three-layer, removable Super Filter System, consisting of a HEPA filter, a carbon filter and an anti-microbial filter. Anti-microbial silver sodium added to the ABS cover provides an additional layer of germ protection
- Owner-adjustable heater (on or off) and air flow

<u>Code</u>	<u>Description</u>	<u>List/ea</u>
20200-1*	High Speed Hand Dryer, 110 - 120V	\$ 763.00
20200-2*	High Speed Hand Dryer, 208 - 240V	763.00

AMER SPEC INC

COMMERCIAL BATHROOM ACCESSORIES

AUTOMATIC ROLL PAPER TOWEL DISPENSER

Special Order



Proximity sensing no-touch unit dispenses pre-set lengths per cycle from 8" or 9" (205 or 230 mm) wide, 800' (244 m) long rolls. Battery operated (4) D-size.

Overall Size
13" X 17-3/4" X 10"

Code	Description	List/ea
8523A*	Automatic Paper Towel Dispenser	\$ 531

COMBINATION PAPER TOWEL DISPENSER & DISPOSAL

Special Order

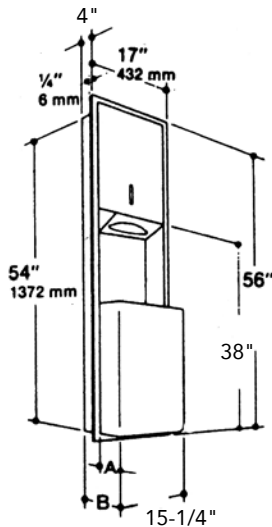

Recessed for 4-1/4" wall depth. Door and frame are 22 gauge stainless steel, satin finish. Capacity: 600 C-fold or 800 multi-fold towels. Waste Container: 12 gallons. A: 4-1/4", B: 8-1/4". Wall opening: 15-3/4" x 54-1/2" x 4-1/4".

Code	Description	List/ea
0469*	Combination Paper Towel Dispenser & Disposal	\$ 429

PAPER TOWEL DISPENSER

Special Order



Surface mounted, 22 gauge stainless steel, satin finish with tumbler lock. Capacity: 400 C-fold or 525 multi-fold towels. Fitted with tumbler lock and heavy duty stainless steel piano hinge.

Overall Size
11" x 14 5/8" x 4 1/16"

Code	Description	List/ea
0210*	Paper Towel Dispenser	\$ 68

TOILET SEAT COVER DISPENSER

Special Order



Surface Mounted, 22 gauge Stainless steel, satin finish. Capacity: 250 covers.

Overall Size
15-3/4"W x 11-1/4"H x 2-5/8"D

Code	Description	List/ea
0477-SM*	Seat Cover Dispenser	\$ 48

FEMININE NAPKIN DISPOSAL

Special Order



Surface Mounted, 22 gauge stainless steel with satin finish. Sloping cover mounted w/ piano hinges. Capacity: .9 gallons (.12 cu ft.)

Overall Size
7-1/2" W X 10" H x 3-7/8" D

Code	Description	List/ea
0852*	Feminine Napkin Disposal	\$ 43

BATHROOM ACCESSORIES

COMMERCIAL GRAB BARS

Stainless Steel

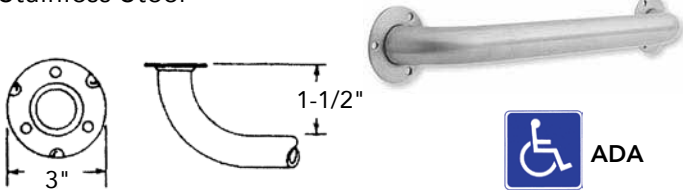

Projection from wall: 1-1/2", Flange Dia: 3"

- Type 304 Satin Stainless Steel Bar with .050" wall thickness (18 Gauge)
- Mounting flanges with .073" wall thickness (14 Gauge)
- Flanges are 3" Diameter with 3 hole mounts
- 2" Stainless Steel mounting screws
- 1-1/2" wall clearance on all bars to meet ADA Code Requirements
- Tested to withstand 1000 lbs. Pull/Push when properly installed
- Concealed flange covers are "snap and twist" type

Code	Size	List/ea
BGBSS-1218E	18"	\$ 34.66
BGBSS-1224E	24"	37.92
BGBSS-1230E	30"	39.91
BGBSS-1236E	36"	47.44
BGBSS-1242E	42"	49.31
BGBSS-1248E	48"	52.01

SHOWER CURTAIN RODS

Franklin Brass



With Adjustable Holder
1" x 5', .015 gauge.
Stainless steel.
No screws needed.

Code	Description	List/ea
FB176H-5	Rod w/ Adjustable Holder	\$ 34.60

RECESSED BATHROOM ACCESSORIES

Franklin Brass



FB606
Soap Holder



FB608
Soap & Utility Bar



FB609
Paper Holder
chrome roller
w/cover



FB607C
Paper Holder
chrome roller



FB600R
Recessed Clamp
(Installation Aid)

All recessed units are solid brass, brilliantly polished and triple plated. Crystal clear polystyrene trays eliminate metal lips that collect dry soap or dirt. Zamak trim, plated with nickel and chrome.

6-1/8" x 6-1/8" overall. Fits 5-1/4" x 5-1/4" x 2" wall opening. Standard installation is by means of screw mounting through back of accessory.

All Polished Chrome Finish.

Code	Description	List/ea
FB600R	Recessed Clamp	\$ 5.04
FB606	Soap Holder	34.62
FB607C	Paper Holder, Chrome Roller	60.35
FB608	Soap Holder w/Utility Bar	25.05
FB609	Paper Holder, w/ cover	57.90

CLOSET TUBING

KV ROUND CLOSET TUBING



KV 660
Stainless Steel

KV 660 tubing 1-1/16" O.D. x 29/32" I.D.
Stainless Steel coated or brass look steel tubing.
Wall thickness: .087"

KV 770 tubing 1-1/16" O.D. x 27/32" I.D.
Chrome look steel tubing. Wall thickness: .109"

KV 770 tubing 1-5/16" O.D. x 1-3/32" I.D.
Chrome look steel tubing. Wall thickness: .109"

<u>Code</u>	<u>Finish</u>	<u>Length</u>	<u>O.D.</u>	<u>List/ea</u>
660-8	Stainless Steel	8'	1-1/16"	\$ 59.29
660-10	" "	10'	1-1/16"	72.07
660-12	" "	12'	1-1/16"	84.51
660BR-6	Brass	6'	1-1/16"	61.18
660BR-8	" "	8'	1-1/16"	81.74
770-6-1116	Chrome	6'	1-1/16"	76.98
770-8-1116	" "	8'	1-1/16"	104.21
770-12-1116	" "	12'	1-1/16"	159.31
770-6-1516	" "	6'	1-5/16"	81.11
770-8-1516	" "	8'	1-5/16"	106.29
770-10-1516	" "	10'	1-5/16"	138.88
770-12-1516	" "	12'	1-5/16"	176.76

SNAP-IN END CAPS FOR 1-5/16" TUBING

Bright Chrome.
50 per box.



#732

<u>Code</u>	<u>Description</u>	<u>List/ea</u>
732	End Cap for 1-5/16" Tubing	\$ 1.98

KV ECONOMY ROUND CLOSET TUBING



KV 750 Chrome
1-1/16" O.D.

1750 Chrome
1-5/16" O.D.

The 750 Closet Tubing is made of slightly thinner material than the 770 tubing. Chrome-look finish.
1-1/16" O.D. x 29/32" I.D. Wall thickness: .075"

<u>Code</u>	<u>Length</u>	<u>O.D.</u>	<u>I.D.</u>	<u>List/ea</u>
750-6-1116	6'	1-1/16"	29/32"	\$ 28.87
750-8-1116	8'	1-1/16"	29/32"	35.47
750-10-1116	10'	1-1/16"	29/32"	42.57
750-12-1116	12'	1-1/16"	29/32"	52.91

Generic Round Tubing

1-5/16" O.D. x 1-5/32" I.D. Wall thickness: .079"

1750-6	6'	1-5/16"	1-5/32"	\$ 25.25
1750-8	8'	1-5/16"	1-5/32"	29.01
1750-10	10'	1-5/16"	1-5/32"	40.64
1750-12	12'	1-5/16"	1-5/32"	49.38

ROUND CENTER SUPPORT FOR CLOSET RODS



Chrome plated finish available for 1-1/16" and 1-5/16" diameters. Oil Rubbed Bronze and Satin Nickel available for 1-5/16" diameter.

<u>Code</u>	<u>Diameter</u>	<u>Finish</u>	<u>List/ea</u>
CRCS-78-CP	1-1/16"	Chrome Plated	\$ 4.09
CRCS-88-CP	1-5/16"	Chrome Plated	5.11
CRCS-88-ORB	1-5/16"	Oil R Bronze	5.31
CRCS-88-SN	1-5/16"	Satin Nickel	5.31

CLOSET HARDWARE

FLANGES FOR 1-1/16" O.D. TUBING



860EP (Chrome)
734BR (Brass)



850EP (Chrome)
735BR (Brass)



632KV
with
5mm pins



757
use with
255 or 233
KV standards

Steel flanges for 1-1/16" O.D. steel tubing. Screw holes on 2" centers. Screws included. Chrome or Brass look.

Code	Finish	Description	Ctn	List/ea
860EP	Chrome	Closed Flange	25 ea.	\$ 3.35
850EP	Chrome	Saddle Flange	25	3.95
734BR	Brass	Closed Flange	50	4.23
735BR	Brass	Saddle Flange	50	4.83
632KV	Chrome	End Flange w/ 5mm pins	100	4.28
757	Chrome	End Flange for 233 / 255 stds	100	.98

FLANGES FOR 1-5/16" O.D. TUBING



861EP



851EP

Flanges for 1-5/16" O.D. steel tubing. Chrome plated steel. With screws.

Code	Finish	Description	Ctn	List/ea
861EP	Chrome	Closed Flange	50 ea.	\$ 6.46
851EP	Chrome	Saddle Flange	25	6.81

ROUND ALUMINUM CLOSET RODS

Oil Rubbed Bronze and Dull Nickel finishes

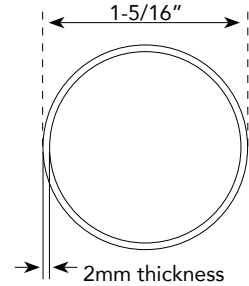

Packed: 20 each/box

Code	Description	List/ea
1516DN-8	1-5/16" x 8', Dull Nickel	\$ 39.47
1516ORB-8	1-5/16" x 8', Oil R Bronze	40.12

FLANGES FOR 1-5/16" ROUND ROD

Oil Rubbed Bronze and Dull Nickel finishes



83310 Closed



83350 Open

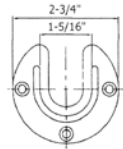

Packed: 100 each/box

Code	Description	Finish	List/ea
83310-DN	Closed Flange	Dull Nickel	\$ 5.04
83310-ORB	Closed Flange	Oil R Bronze	5.04
83310-CR	Closed Flange	Chrome	4.35
83350-DN	Open Flange	Dull Nickel	5.31
83350-ORB	Open Flange	Oil R Bronze	5.31
83350-CR	Open Flange	Chrome	4.47

FLANGES W/ 5MM PINS FOR 1-5/16" ROUND ROD



83351 Open



83311 Closed



Code	Description	Finish	List/ea
83311-DN	Closed, w/ 5mm pins	Dull Nickel	\$ 3.86
83311-ORB	Closed, w/ 5mm pins	Oil R Bronze	3.86
83311-CR	Closed, w/ 5mm pins	Chrome	4.42
83351-DN	Open, w/ 5mm pins	Dull Nickel	3.90
83351-ORB	Open, w/ 5mm pins	Oil R Bronze	3.90
83351-CR	Open, w/ 5mm pins	Chrome	4.42

CLOSET HARDWARE

KV OVAL CLOSET TUBING



880



881 flange
front back

Strong oval shaped tubing is made of heavy gauge steel. Welded seam adds additional strength. Easy to cut. Chrome-look steel. 30mm H x 15mm W x 1.2mm thick.

Flange has 5mm anchor pins to fit 32mm mounting hole patterns. Also has screw hole for extra strength. Chrome look finish. 1-3/4" H x 3/4" W.

Code	Description	Ctn	List/ea
880-8	8' Chrome Oval Tubing	1 ea.	\$ 18.48
880-12	12' Chrome Oval Tubing	1	25.87
881	Flanges for Oval Tubing	50	1.41

OVAL CLOSET RODS

Seamless Steel, 9.85' & 12' lengths



Chrome Plate
Thickness = 1mm

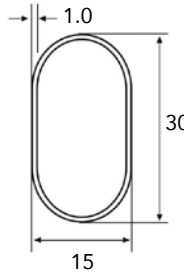

Code	Length	Finish	Ctn	List/ea
30X15-3M	9.85'	Chrome Plate	10	\$ 13.65
30X15-12	12'	Chrome Plate	10	21.92

FLANGES FOR OVAL RODS

Chrome or Brass Plate

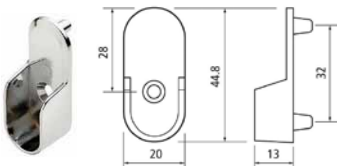

C8339
w/ 5mm pins

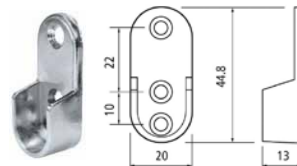

C8339200300
no pins

Code	Description	Ctn	List/ea
C8339	Chrome, 5mm pins	1000	\$.67
C8339-BR	Brass, 5mm pins	1000	.68
C8339200300	Chrome, no pins	1000	.69
C8339200400	Brass, no pins	1000	.56

OVAL ALUMINUM CLOSET RODS

Oil Rubbed Bronze and Dull Nickel finishes



15mm x 30mm,
1.5mm thick

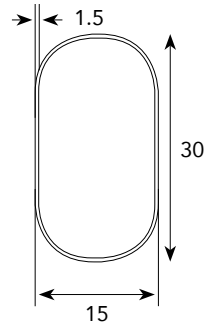

Packed: 20 each/box

Code	Description	List/ea
30X15DN-8	8', Dull Nickel	\$ 23.81
30X15ORB-8	8', Oil R Bronze	23.76

FLANGES FOR OVAL ROD

Oil Rubbed Bronze and Dull Nickel finishes



83391
5mm pin

83392
Screw-on

Code	Description	Finish	List/ea
83391DN	5mm pins	Dull Nickel	\$ 1.68
83391ORB	5mm pins	Oil R Bronze	1.76
83392DN	Screw-On	Dull Nickel	1.62
83392ORB	Screw-On	Oil R Bronze	1.54

OVAL CENTER SUPPORTS FOR CLOSET RODS

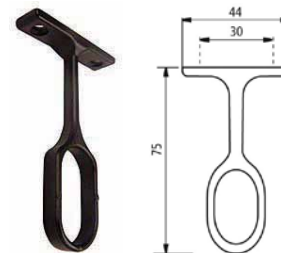

Oval center supports
Overall length: 2.95"
(75mm)

Code	Finish	List/ea
661CH	Polished Chrome	\$ 1.97
661DN	Dull Nickel	1.97
661ORB	Oil R Bronze	1.97

CLOSET HARDWARE

KV NO. 2 EXTENSION CLOSET ROD



Adjustable rods to fit closet to 144" wide. Has an improved end flange to simplify installation to hook rail. Rods individually packed in polybags. Bright Nickel Plate Finish. One each per bag.

<u>Code</u>	<u>Description</u>	<u>List/ea</u>
KV2-18	Closet Rod, 18" to 30"	\$ 7.23
KV2-30	Closet Rod, 30" to 48"	8.82

KV No. 29201 CENTER SUPPORT



Fits KV #2 and similar closet rods to provide additional support for heavy loads. Anochrome Finish.

12 ea/box.

<u>Code</u>	<u>Description</u>	<u>List/ea</u>
29201NP	Center Support, 2-41/64" H	\$ 3.10

WADDELL HARDWOOD SOCKETS

Hardwood clothes pole sockets are designed to anchor the end of standard 1-3/8" wooden clothes poles. The 410 socket is sturdier than the 408. Both are 1-3/8". Polybagged with 1 ea. open socket, 1 ea. closed socket and screws.



408DP
Economy Socket



410DP
Heavy Duty Socket

<u>Code</u>	<u>Description</u>	<u>Ctn</u>	<u>List/bg</u>
408DP	Economy Sockets, 1-3/8"	25 bgs	\$ 1.79
410DP	Heavy Duty Sockets, 1-3/8"	15	2.00

BAINBRIDGE PLASTIC POLE SOCKETS



1323WH

1-3/8" Plastic pole sockets packed 1 pair per bag, 500 bags per box with screws. White plastic.

<u>Code</u>	<u>Description</u>	<u>Ctn</u>	<u>List/pr</u>
1323WH	Plastic Sockets, 1-3/8"	500 pr	\$.96

CLOSET RODS

Solid Hemlock in 8' lengths



138-8

<u>Code</u>	<u>Description</u>	<u>Ctn</u>	<u>List/ea</u>
138-8	1-3/8" x 8' Rods	10 ea.	\$ 19.16

CLOSET HARDWARE

KV No. 1 CLOTHING CARRIER



KV1

Double the hanging space in any closet with this ball-bearing clothing carrier. Pull, and the entire carrier slides out into the room. A sliding sleeve allows up to 6" adjustment in length. Bright Nickel Plate finish. 1 per box.

Code	Size	Closet Depth	List/ea
KV1-10	10"	to 12"	\$ 37.00
KV1-12	12"	to 16"	43.29
KV1-16	16"	to 20"	43.39
KV1-20	20"	to 24"	53.58

KV No. 3 GARMENT BRACKET

Heavy duty garment bracket holds 6 or more garments on coat hangers. 1/2" steel rod with safety end welded to heavy steel flange. Anochrome finish. Screws included.



KV3

Code	Size	Ctn	List/ea
KV3-5.5	5-1/2" Length	10 ea.	\$ 18.62
KV3-10	10" Length	10	17.60

KV STATIONARY GARMENT BRACKET

Durable steel utility hook. Anochrome finish.



1132-10

Code	Size	Ctn	List/ea
1132-10	10" Length	12 ea.	\$ 7.65

SHELF & ROD SUPPORT BRACKET



DD06-31WC

- 12-1/2" projection from mounting surface
- Overall size: 15/16" W x 10-1/4" H
- White in color

Shelf and pole bracket is normally used where pole is sagging and a double strength unit cannot be installed. Screws included.

Code	Color	Ctn	List/ea
DD06-31WC	White	20 ea.	\$ 1.97

ADJUSTABLE SHELF & ROD SUPPORT BRACKET



DD06-32WC

- 12-1/2" projection from mounting surface
- Overall size: 15/16" W x 10-1/4" H
- White in color

For shelves up to 12" wide. Adjustable shelf and pole bracket installs either on a wall or hook strip. White. Screws are included.

Code	Color	Ctn	List/ea
DD06-32WC	White	20 ea.	\$ 3.33

FIXED SHELF & ROD SUPPORT BRACKET



DD06-33WC

- 12-1/4" projection from mounting surface
- Overall size: 15/16" W x 10-1/2" H
- White in color

Tear drop mounting hole for easy installation. Riveted construction.

Code	Color	Ctn	List/ea
DD06-33WC	White	20 ea.	\$ 3.59

12



CLOSET ACCESSORIES



PULL-OUT WIRE BASKETS

CB Series - Heavy Gauge Wire Baskets



Bayonet mounting



ORB 18" x 11" Basket

Heavy-gauge pull-out wire baskets fits 32mm applications. Basket mounting & removal is fast and simple. Basket rests on top of slides, eliminating the torque twist that is inherent in other designs. Bayonet mounting system. Pack: 5/Carton.

Specify "CR" for Chrome, "SN" for Satin Nickel, "ORB" for Oil Rubbed Bronze.

14" Depth	W x H	ORB	CR	SN
CB-181407	18" x 7"	\$ 37.27	\$ 46.36	\$ 38.32
CB-181411	18" x 11"	39.03	39.42	40.95
CB-181418	18" x 18"	52.09	45.96	50.23
CB-241407	24" x 7"	44.50	41.80	47.58
CB-241411	24" x 11"	47.24	50.31	49.84
CB-241418	24" x 18"	57.69	54.11	55.48
CB-301407	30" x 7"	46.24	45.33	50.10
CB-301411	30" x 11"	51.58	50.24	52.35
CB-301418	30" x 18"	62.65	56.89	62.67

16" Depth				
CB-181607	18" x 7"	40.16	38.41	41.44
CB-181611	18" x 11"	48.34	40.32	44.08
CB-181618	18" x 18"	57.63	47.96	52.56
CB-241607	24" x 7"	42.34	49.53	49.53
CB-241611	24" x 11"	50.04	47.96	52.35
CB-241618	24" x 18"	58.63	53.57	59.00
CB-301607	30" x 7"	47.92	50.35	54.38
CB-301611	30" x 11"	54.65	54.38	59.24
CB-301618	30" x 18"	67.88	63.22	66.02

20" Depth				
CB-182007	18" x 7"	-	42.93	-
CB-182011	18" x 11"	-	49.09	53.99
CB-182018	18" x 18"	-	55.99	61.66
CB-242007	24" x 7"	-	47.68	-
CB-242011	24" x 11"	-	54.97	59.12
CB-242018	24" x 18"	-	60.12	66.39

CLOTH HAMPER BAGS FOR CB SERIES BASKETS

Black in Color



Hamper bag insert for use with the CB Series Baskets. Stylish black liner is made of durable, machine washable canvas, features Velcro ties and black coated handles.

Pack: 5/Carton.

Code	Dimensions	List
CHBI-241418	For 24" W x 14" D x 18" H	\$ 34.06
CHBI-241618	For 24" W x 16" D x 18" H	34.80
CHBI-242018	For 24" W x 20" D x 18" H	40.13
CHBI-301418	For 30" W x 14" D x 18" H	39.14
CHBI-301618	For 30" W x 16" D x 18" H	40.37

CLOTH LINERS FOR CB SERIES BASKETS

Cloth basket liners are machine washable and designed to fit tight and secure in Rev-A-Shelf CB Series baskets. With hook and loop fasteners. All tan in color except where noted.



14" Depth	Dimensions	Color	List
CBL-181411-T	18"W x 14"D x 11"H	Tan	\$ 15.67
CBL-181418-T	18"W x 14"D x 18"H	Tan	21.00
CBL-241411-T	24"W x 14"D x 11"H	Tan	15.98
CBL-241418-T	24"W x 14"D x 18"H	Tan	21.27
CBL-301411-T	30"W x 14"D x 11"H	Tan	16.37
CBL-301418-T	30"W x 14"D x 18"H	Tan	21.30

16" Depth			
CBL-241611-B-1	24"W x 16"D x 11"H	Black	25.24

20" Depth			
CBL-182011-T	18"W x 20"D x 11"H	Tan	17.01
CBL-182018-T	18"W x 20"D x 18"H	Tan	24.65
CBL-242011-T	24"W x 20"D x 11"H	Tan	19.82
CBL-242018-T	24"W x 20"D x 18"H	Tan	26.79



CLOSET ACCESSORIES

TOP MOUNT BRACKET FOR CB SERIES BASKETS

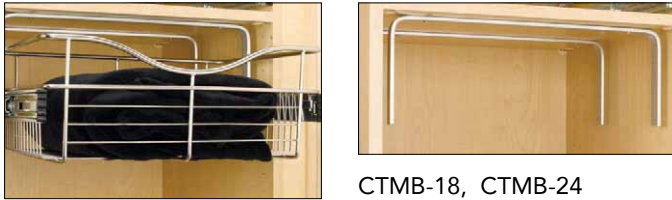

CTMB-18, CTMB-24

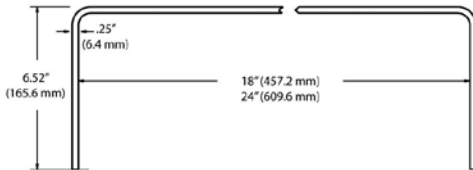

This top mount bracket mounts CB Series wire baskets in openings that are not the standard 18" or 24" widths. Simply mount the bracket to the underside of a shelf and then attach the basket to the brackets. The minimum openings for the top mount brackets are 18-1/2" and 24-1/2".

Pack: 5 pr/Cartron.

Code	Description	Min. Opening	List/pr
CTMB-18	For 18" Basket	18-1/2"	\$ 19.44
CTMB-24	For 24" Basket	24-1/2"	21.12

WIRE HAMPER WITH SOFT-CLOSE SLIDES

CH Series



CH-241419-RM-217



5CHB-LINER
(Sold Separately)

- Two removable wire baskets and machine washable cloth liners.
- Silver polymer base
- Bottom mount full extension slides
- Soft-Open/Soft Close Rev-A-Motion™ technology
- Includes door mount brackets



24" W x 13-15/16" D x 18-7/8" H

Code	Description	List/ea
CH-241419-RM-217	Double Wire Hamper w/ 2 Canvas Liners	\$ 328.94
5CHB-LINER	Replacement Liners	12.26

TILT-OUT HAMPER BASKET

CTOHB Series



Door mount the basket to a bottom hinged cabinet for easy one step "Slide-In/Slide-Out" basket removal. Available in Chrome, Satin Nickel and Oil Rubbed Bronze. Durable 6.6 mm wire has a cap. of 55 qts for the 16" wide unit and 74 qts for the 21" wide unit. All models 13-1/2" D and 19-3/4" H.

Code	Width	Finish	List/ea
CTOHB-161319-CR	15-1/2"	Chrome	\$ 65.18
CTOHB-211319-CR	20-1/2"	Chrome	73.41
CTOHB-161319-SN	15-1/2"	Satin Nickel	73.41
CTOHB-211319-SN	20-1/2"	Satin Nickel	81.67
CTOHB-161319-ORB	15-1/2"	Oil R Bronze	73.44
CTOHB-211319-ORB	20-1/2"	Oil R Bronze	81.62

Removable Hamper Bags for CTOHB Baskets

Machine washable Black or Tan Cloth Liners. Designed to fit tight and securely with hook and loop fasteners. Strong handles for easy transport and removal.



12

Code	Description	List/ea
CTOHB-16-I-1	Black Liner for 16" Basket	\$ 35.03
CTOHB-21-I-1	Black Liner for 21" Basket	39.74
CTOHT-16-I-1	Tan Liner for 16" Basket	37.63
CTOHT-21-I-1	Tan Liner for 21" Basket	39.77

REV-A SHELF SLIDE-OUT POLYMER HAMPER

14" Depth For Closet applications

2.3 Bushel (63 qt) capacity in this easily removable hamper. Includes detachable lid. For door mount, order with RV-DM KIT.

Contains 1 polymer hamper with frame and full extension slides. Fully assembled.



Code	Dimensions	List/ea
HPRV1925S	19-7/8" W x 24" H x 14" D	\$ 155.51



CLOSET ACCESSORIES



WIRE SHOE RAIL

CSR Series



Add functionality to your closets. Available in 17", 23", 29" and 35" lengths, this shoe rail system is easy to install and features heavy gauge railing. Height: 2-1/4".

Available in Chrome, Satin Nickel and Oil Rubbed Bronze finishes Pack: 10 ea/box.

Code	Length	Finish	List/ea
CSR-17CR	17"	Chrome	\$ 4.08
CSR-23CR	23"	Chrome	5.69
CSR-29CR	29"	Chrome	6.70
CSR-35CR	35"	Chrome	7.79
CSR-17SN	17"	Satin Nickel	5.32
CSR-23SN	23"	Satin Nickel	6.69
CSR-29SN	29"	Satin Nickel	7.71
CSR-35SN	35"	Satin Nickel	8.79
CSR-17ORB	17"	Oil R Bronze	6.55
CSR-23ORB	23"	Oil R Bronze	8.03
CSR-29ORB	29"	Oil R Bronze	9.24
CSR-35ORB	35"	Oil R Bronze	10.77

WIRE FAN PANTS RACK

CPRF Series

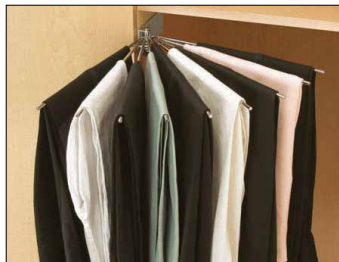

CPRF-16CR

Chrome plated fan pants rack. Simple installation via the system holes, universal left or right side wall mounting. For an 18" width x 16" deep opening. An easy way to add storage for nine pairs of pants. Rubber O-rings keep pants from slipping, polished ends prevent snagging.

Code	Opening	Ctn	List/ea
CPRF-16CR	18" W x 16" D	2	\$ 18.82

PULL-OUT PANTS RACK

PSC Series

- Heavy gauge chrome
- Pull-out frame with moveable 'fingers' for easy access
- Full extension slides



14" Depth, 3" Height

Code	Width	Capacity	List/ea
PSC-1814CR	17-1/2" - 18-1/8"	9 pair	\$ 110.10
PSC-2414CR	23-3/4" - 24-1/2"	13 pair	132.90
PSC-3014CR	29-3/4" - 30-1/2"	16 pair	148.60

SOLID WOOD DISPLAY RACK - For Pants and Ties

CW Series



CWTR Tie Rack
24"



CWPR Pant Rack
24", 30"

These pull-out racks feature full-extension slides, rubber O-rings to prevent slipping and removable pant rods for ease of use. Made from solid birch/maple. Removable front for drawer head mounting. All models 14-3/8" deep and 6" high. Clear Finish.

Pant rack comes in a 24" or 30" width and has space for 18 standard or 12 Big & Tall pants. Removable pant rods for ease of use. The CWTR tie rack can hold over 120 ties.

Code	Description	Width	List/ea
CWPR-2414	24" Pants Rack	24"	\$ 118.83
CWPR-3014	30" Pants Rack	30"	132.63
CWTR-2414	24" Tie Rack	24"	140.69

CLOSET ACCESSORIES

JEWELRY DRAWERS
CJD Series



Shown drawer front mounted with multiple jewelry drawers / inserts.

CJD-24IN
(w/ Necklace Insert)

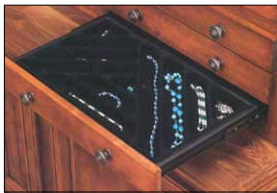

CJD-24IS
(w/ Jewelry Insert)

Keeps jewelry organized; easily installed with system holes and features black full-extension ball-bearing slides. Drawer head mounting capability. Use in coordination with the CJD-24IS (Jewelry) and CJD-24IN (Necklace) inserts.

These unique inserts store large items like necklaces without tangling. The curved inside radius allows full access to small items such as earrings and rings. Inserts feature "drop-in" installation and a soft, velvet flocked covering.



Optional Drawer Front Mount Kit (Sold Separately).

CJD-DMB-KIT

Code	Dimensions
CJD-2414	24" W x 14" D x 1-7/8" H
CJD-24IS	22" W x 13" D x 1-1/2" H
CJD-24IN	22" W x 13" D x 1-1/2" H

Code	Description	List
CJD-2414	Jewelry Drawer w/Slides	\$ 98.85
CJD-24IS	Jewelry Insert	54.75
CJD-24IN	Necklace Insert	54.75
CJD-DMB-KIT	Drawer Front Mount Brkt	3.97

PULL-OUT CLOSET MIRROR
CM-1448



- Installs in a space just over 3-1/2" wide
- Soft-Open, Soft-Close slide system
- Reversible mounting
- Adjustable 60° pivot
- Easy installation



Angle of mirror can be adjusted by up to 60°

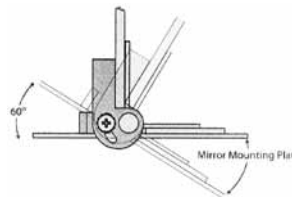

Minimum Opening
(Width): 3-1/2"



48" long mirror installs in a space just over 3-1/2" wide. It features a soft-open, soft-close slide system, reversible mounting, a sleek design and comfortable handle, adjustable 60 degree pivot and easy installation with only 8 screws.

Dimensions: 3-1/2" W x 14" D x 48" H		
Code	Finish	List/ea
CM-1448-SN	Satin Nickel	\$ 368.32
CM-1448-ORB	Oil Rubbed Bronze	368.32

CLOSET ACCESSORIES



ACRYLIC SHELF ORGANIZERS

CSPD Series



Create your own custom storage with these Acrylic Shelf Organizers. Mounts utilizing 32 mm system holes. Clips are inserted into notches cut into the acrylic to hold dividers secure. These clear dividers can organize just about anything in your closet.

CSPD-14

Code	Dimensions	List/ea
CSPD-14	13-1/2"D x 14-1/8"H x 1/4" thick	\$ 31.83

PULL-DOWN CLOSET ROD

CPDR Series



CPDR-2635

Pull-Down Closet Rod is available in 3 sizes and features an adjustable rod length to accommodate openings from 18" to 26" (CPDR-1826), 26" to 35" (CPDR-2635) and 35" to 48" (CPDR-3548). The telescoping pull-rod adjusts from 34" to 50" to accommodate universal design and handi-cap accessible applications. Chrome and black.

Code	Description	List/ea
CPDR-1826	21-1/2" - 26"	\$ 120.26
CPDR-2635	26" - 35"	125.94
CPDR-3548	35" - 48"	132.64
CPDR-STP-1	Heavy Duty Rod Stop	12.76

SPIRAL CLOTHES RACK

SHR Series



SHR-84



360° Turning Radius

This perfect corner closet solution has a 360-degree turning radius with an adjustable height of 72-1/2" to 84" and the ability to hang 40 single items of clothing from top to bottom. The SHR-84 comes complete with a stabilizer bar, post and pivot hardware, and mounting hardware.

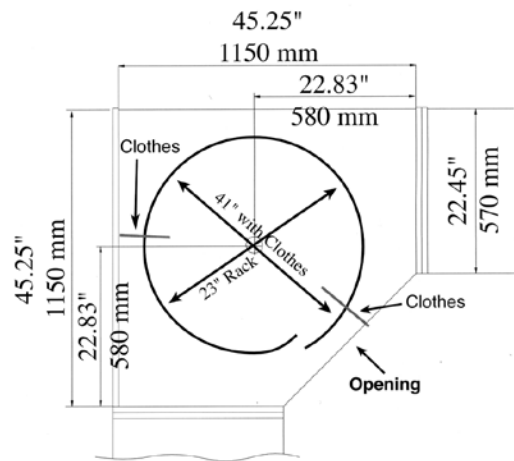

Code	Overall Dimensions	List/ea
SHR-84	23" W x 72-1/2" - 84" H	\$ 291.82



CLOSET ACCESSORIES

STANDARD VALET ROD

CVL Series



12" Standard Valet Rod installs easily with only four screws. Offered in Chrome, Satin Nickel, and Oil Rubbed Bronze, and features unique removable pull for easy customization to your current closet hardware. (8/32" thread)

Rod Dimensions: 11-7/8" to 17-7/8" Length.

Code	Finish	List/ea
CVL-12CR	Chrome	\$ 18.28
CVL-12SN	Satin Nickel	16.95
CVL-12ORB	Oil R Bronze	17.36

DESIGNER VALET ROD

CVR Series

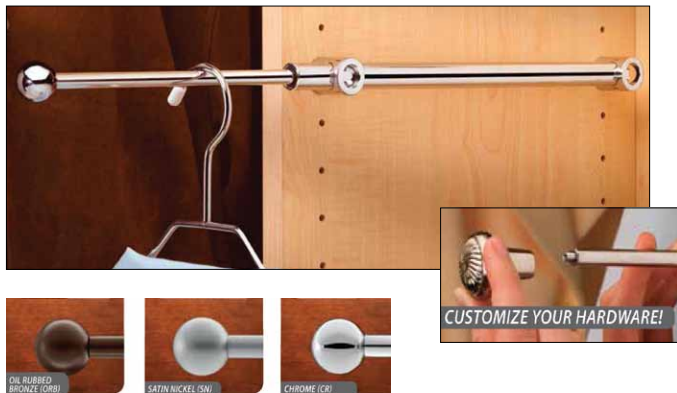

Designer Valet Rod has an 8-3/16" telescoping rod. For 14" depth closet panels. Adjustable mounting bracket for various system hole applications. Removable knob to customize hardware (8/32" thread)

Rod Dimensions: 13-7/8" to 21-7/8" Length.

Code	Finish	List/ea
CVR-14CR	Chrome	\$ 22.94
CVR-14SN	Satin Nickel	22.94
CVR-14ORB	Oil R Bronze	21.80

CLOSET ORGANIZERS

CTR / CBSR Series



CTR - Tie/Scarf Organizer



CBSR - Belt/Scarf Organizer

Easily installs with two Euro screws.



Tie/Scarf Organizer holds up to 15 ties or scarves and Belt Organizer holds up to six belts. Both feature clear non-slip soft PVC coated hooks. Fully accessible 8-3/16" telescoping rod. For 14" depth closet panels. Adjustable mounting bracket for various system hole applications. Removable knob to customize hardware (8/32" thread).

Rod Dimensions: 13-7/8" to 21-7/8" Length.

Code	Organizer	Finish	List/ea
CTR-14CR	Tie/Scarf	Chrome	\$ 30.17
CTR-14SN	" "	Satin Nickel	31.04
CTR-14ORB	" "	Oil R. Bronze	42.06
CBSR-14CR	Belt/Scarf	Chrome	26.63
CBSR-14SN	" "	Satin Nickel	29.23
CBSR-14ORB	" "	Oil R. Bronze	36.66

INSERT VALET ROD

CVRI Series

Rod can open or close the 3-1/3" with a single finger. Fits within 3/4" and larger closet panels.

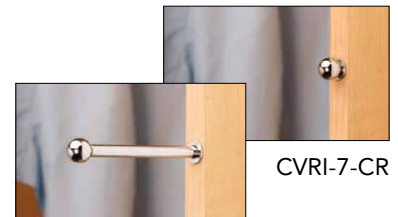

Dimensions: 3-3/4" - 7-3/8" L. Chrome or Satin Nickel. Drill Guide w/ Bit (CVRI-DG) is available to simplify drilling for installation and includes a 1/2" drill bit.

Code	Description	Finish	List/ea
CVRI-7-CR	Insert Valet Rod	Chrome	\$ 16.81
CVRI-7-SN	Insert Valet Rod	Satin Nickel	16.48
CVRI-DG	Drill Guide w/ Bit		62.91



CLOSET ACCESSORIES



PULL-OUT SIDE MOUNT TIE RACK

TRC Series



- Holds up to 25 ties
- Full extension ball-bearing slide
- Available in Chrome, Satin Nickel or Oil Rubbed Bronze

Dimensions:

2-1/2" W x 14" D x 1-7/8" H

Code	Finish	List/ea
TRC14CR	Chrome	\$ 29.02
TRC-14SN	Satin Nickel	23.30
TRC-14ORB	Oil R Bronze	23.30

Reverse Mounting Bracket:

Designed so you can utilize the unused space between the wall and the end of the run. Works with the TRC Series tie rack and BRC Series belt rack. Features a sleek chrome finish.



11" D x 3-3/4" W x 2-5/8" H

Code	Description	List/ea
CRMB-12CR	Reverse Mounting Bracket	\$ 12.99

PULL-OUT SIDE MOUNT BELT RACK

BRC Series



BRC-14
Belt Rack w/
Nine hooks

Pull-out belt storage system - available in three finishes. Designed to hold belts neatly, is completely accessible and fits any 14" depth closet application.

Dimensions:

2-1/2" W x 14" D x 1-7/8" H

Code	Finish	List/ea
BRC-14CR	Chrome	\$ 19.92
BRC-14SN	Satin Nickel	23.30
BRC-14ORB	Oil R Bronze	23.30

TIE AND BELT RACK WITH TRAY

TBC Series



Pull-out tie and belt rack with black top storage tray. Full extension slide. Holds 20 ties, 5 belts, and 4 peg closure belts. Fully assembled. Chrome finish.

Dimensions:

6" W x 5"H x 14"D

Code	Description	List/ea
TBC-14TCR	Tie/Belt Rack w/ Tray	\$ 72.94

SHAKER PEGS

**WOODEN
HANGING PEGS**



Hardwood Shaker Pegs, unfinished. An ideal peg for hanging coats, hats, etc. Overall Length: 3-1/2". Head Dia: 1", Base Dia: 3/4", Stem Dia: 1/2".

<u>Code</u>	<u>Packaging</u>	<u>Ctn</u>	<u>List</u>
CP4	2 ea/ polybag	12 bgs	\$ 2.12 /bg
760B	100 ea/ bulk	100 ea	.66/ea

Oak Shaker Pegs:

CP9	1 ea/ polybag	12 bgs	\$ 2.12 /bg
-----	---------------	--------	-------------

Mini Shaker Pegs: O/A Length: 2"

CP11	3 ea/ polybag	12 bgs	\$ 2.12 /bg
------	---------------	--------	-------------

SHAKER PEGS



Birch wood. 100/box.

<u>Code</u>	<u>Size</u>	<u>List/C</u>
HP-1BIR	3-1/2" x 7/8" x 1/2" stem	\$ 37.37

12

**SCREW-ON
SHAKER PEGS**



Birch wood. 100/box.

<u>Code</u>	<u>Size</u>	<u>List/C</u>
HP-1SCR	3-1/2" x 7/8" x #10 screw	\$ 117.22

**JUMBO
SHAKER PEGS**



Birch wood. 100/box.

<u>Code</u>	<u>Size</u>	<u>List/C</u>
CP-1BIR	5-1/8" x 1-1/4" x 3/4" stem	\$ 92.00



HOOKS

SUGATSUNE

STAINLESS STEEL HOOKS

Mirror finish and supplied with stainless steel screws



Load Cap: 44 lbs.

Code	Overall Proj.	Ht	Pk	List/ea
EL25	1-1/16"	1-7/16"	30	\$ 9.50
EL30	1-5/16"	2-3/16"	20	12.64

EL Series



Load Cap: 44 lbs.

Code	Overall Proj.	Ht	Pk	List/ea
EP25	1"	1"	30	\$ 9.50
EP40	1-5/16"	1-3/8"	20	11.93

EP Series



FC Series

Code	Proj.	Ht	Load Cap	Pk	List/ea
FC50	1-7/8"	1-1/2"	22 lbs.	30	\$ 11.32
FC65	2-9/16"	1-3/4"	26	20	13.61

STAINLESS STEEL HOOKS

Polished stainless steel finish



TY Series

Code	Hook Proj.	Hook Ht	Screw Length	Load Cap	Ctn	List/ea
TY-25	1-1/16"	11/16"	13mm	6.6 lbs	100	\$.61
TY-30	1-7/32"	13/16"	15mm	15.4	100	.71
TY-35-15	1-7/16"	15/16"	20mm	15.4	50	1.01
TY-40-15	1-23/32"	1-1/16"	20mm	17.6	50	1.42



TF Series

Code	Hook Proj.	Hook Ht	Screw Length	Load Cap	Ctn	List/ea
TF-20	13/16"	13/16"	11mm	6.6 lbs	200	\$.61
TF-30	1-5/32"	1-1/32"	15mm	15.4	100	1.21
TF-35	1-5/8"	1-3/8"	20mm	26	50	1.52



TL Series

Code	Hook Proj.	Hook Ht	Screw Length	Load Cap	Ctn	List/ea
TL-20	29/32"	25/32"	11mm	11 lbs	100	\$.59
TL-30	1-5/32"	1"	15mm	11	100	.88
TL-40	1-19/32"	1-11/32"	20mm	26	50	1.60

STAINLESS STEEL SWING HOOKS

With Friction



- Swivels 180 degrees
- Hook has constant torque when swiveling
- Ideal for vibration or shock applications
- Screws included
- Polished stainless steel finish

Code	Overall Ht	Proj	Overall Width	Load Cap	Ctn	List/ea
TK-30F	.57"	1-27/64"	1-3/8"	26 lbs	100	\$ 2.63
TK-45F	.76"	1-3/4"	1-3/8"	17	100	2.83

CLOSET HOOKS

IVES CEILING HOOK

Base: 1" H x 1-7/8" W
Proj: 2-1/4"



<u>Code</u>	<u>Finish</u>	<u>Ctn</u>	<u>List/ea</u>
SP580A92	Aluminum	25 ea	\$ 2.32
SP580A3	Polished Brass	25	2.22

IVES SINGLE WARDROBE HOOK

Base: 1-1/8" x 1-1/8"
Proj: 1-11/16"



<u>Code</u>	<u>Finish</u>	<u>Ctn</u>	<u>List/ea</u>
SP581A92	Aluminum	25 ea	\$ 1.42
SP581A3	Polished Brass	25	1.42

IVES DOUBLE WARDROBE HOOK

Base: 1-1/8" x 1-1/8"
Proj: 1-1/8"



<u>Code</u>	<u>Finish</u>	<u>Ctn</u>	<u>List/ea</u>
SP582A92	Aluminum	25 ea	\$ 1.42
SP582A3	Polished Brass	25	1.98

HICKORY HARDWARE
MANOR HOUSE HOOK

Ant. Brass & Porcelain

Steel, Ant. Brass, & White Porcelain.
Height: 5-1/2", Proj: 4".
5 each per box.



<u>Code</u>	<u>List/ea</u>
P79LP	\$ 20.00

IVES COAT HOOKS

Cast Metal

Base: 1-3/4" H x 1-1/4" W
Proj: 3"



<u>Code</u>	<u>Finish</u>	<u>Ctn</u>	<u>List/ea</u>
SP571A92	Aluminum	25 ea	\$ 1.21
SP571A3	Polished Brass	25	1.21
SP571A5	Antique Brass	25	1.54
571AW	White	10	1.95

SOLID BRASS COAT HOOKS

Baldwin

Height: 2-1/4"
Proj: 3"



10/box with screws.

<u>Code</u>	<u>Finish</u>	<u>Ctn</u>	<u>List/ea</u>
0740-150	Satin Nickel	10 ea	\$ 20.22
0740-260	Polished Chrome	10	20.22



HANDRAIL BRACKETS

IVES HANDRAIL BRACKETS



Code	Size	Base to Center of rail
059	2-1/4" H x 1-3/8" W	2-7/16"
59	2-13/16" H x 1-1/2" W	2-3/4"

Plated Steel. Polybagged with screws.

Code	Finish	Ctn	List/ea
59A10B	Oil R Bronze	10 bgs	\$ 5.26
59A15	Satin Nickel	10	5.26
SP59A3	Polished Brass	15	3.12
SP59A92	Aluminum	15	3.12
059AW	White	10	3.86
SP059A92	Aluminum	20	2.95
059A10B	Oil R Bronze	20	2.93
SP059A3	Polished Brass	20	3.05

PARKER HANDRAIL BRACKET

Solid Brass

Solid cast brass handrail brackets. Polished Brass Finish. Projection is 3". For 2" O.D. tubing. 3 screw holes.



Code	Finish	Ctn	List/ea
180-2	Polished Brass	1	\$ 32.56

Handrail Bracket with Stud: Same as above bracket but with stud. 3" projection.

Code	Finish	Ctn	List/ea
180S-2	Polished Brass	1	\$ 34.09

DELTA HANDRAIL BRACKET

Solid Brass - For Flat Rail

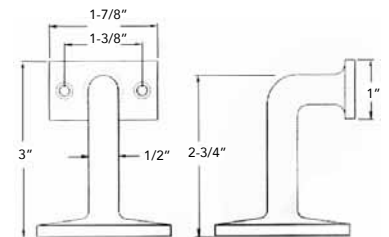

Projection: 3"
Base Size: 2-1/4" Dia.
Finish: Polished Brass

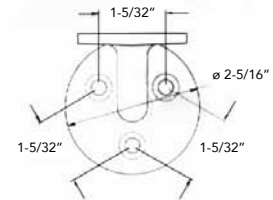

Code	Description	List/ea
HRC253US3	Hand Rail Bracket, Polished Brass	\$ 23.82

12

Solid Brass

Code	Finish	Ctn	List/ea
59MB26	Polished Chrome	10 ea.	\$ 21.02
59MB15	Satin Nickel	10	21.18
59MB3	Polished Brass	10	18.20
059B15	Satin Nickel	10	19.66
SP059B10B	Oil R Bronze	10	19.52

LAVI

BAR RAILING

**LAVI SOLID BRASS
BAR RAILING AND FITTINGS**

All in Polished Brass Finish. Screws included.

Stainless Steel available Special Order.



BRASS RAILING



Polished brass finish.
.050 thickness. 1-1/2" or 2"
O.D. Available in 6' or 12'
lengths only.

Code	O.D.	Length	List/ea
A110-00-6	1-1/2"	6'	\$ 158.80
A110-00-12	1-1/2"	12'	309.79
A120-00-6	2"	6'	197.47
A120-00-12	2"	12'	388.00

HANDRAIL BRACKET

112 for
1-1/2" rail.
2 for 2" rail.

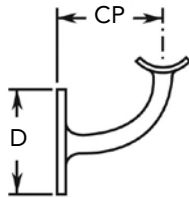

Code	CP	D	List/ea
301-112	2-3/4"	2-1/2"	\$ 29.81
301-2	2-5/8"	2-1/2"	27.25

**FLUSH END POST
(Closed End)**

112 for
1-1/2" rail.
2 for 2" rail.

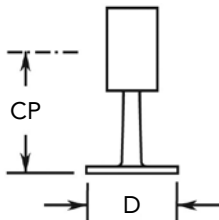

Code	CP	D	List/ea
340-112	2-7/16"	2-5/16"	\$ 29.64
340-2	3-1/4"	2-1/2"	30.86

Recommended: Footrail bracket every 3' of rail.
Handrail bracket every 3-4' of rail.

**FLUSH
CENTER POST**

112 for
1-1/2" rail.
2 for 2" rail.

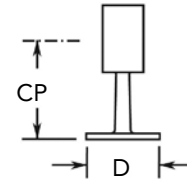

Code	CP	D	List/ea
342-112	2-7/16"	2-5/16"	\$ 28.47
342-2	3-1/4"	2-1/2"	32.11

FOOTRAIL BRACKET

112 for
1-1/2" rail.
2 for 2" rail.

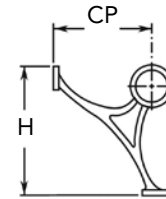

Code	CP	H	List/ea
400-112	6-1/8"	6-1/4"	\$ 39.48
400-2	6-3/8"	7"	40.60

BAR MOUNT BRACKET

112 for
1-1/2" rail.
2 for 2" rail.

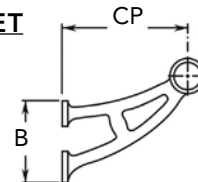

Code	CP	B	List/ea
402-112	6-1/16"	4"	\$ 43.24
402-2	6-7/8"	4-1/4"	43.95

FLOOR BRACKET

For 2" rail.

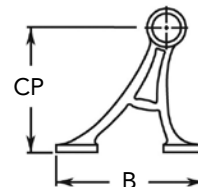

Code	CP	B	List/ea
404-2	8-3/8"	4-11/16"	\$ 52.39



BAR RAILINGS

LAVI

**LAVI SOLID BRASS
BAR RAILING AND FITTINGS**

All in Polished Brass Finish. Screws included.

Stainless Steel available Special Order.



**BALL
ELBOW**

112 for
1-1/2" rail.

2 for 2" rail.

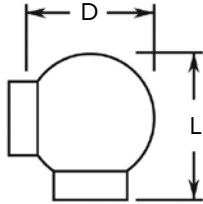

Code	D	L	List/ea
702-112	2-1/2"	3"	\$ 19.82
702-2	3-1/4"	3-3/4"	25.30

**SCROLL
FINIAL**

112 for
1-1/2" rail.

2 for 2" rail.

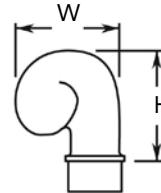

Code	W	H	List/ea
606-112	2-3/4"	2-7/8"	\$ 34.66
606-2	3"	3-1/8"	48.15

**FLUSH RADIUS
ELBOW**

112 for
1-1/2" rail.

2 for 2" rail.

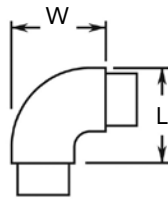

Code	W	L	List/ea
731-112	2-7/8"	2-7/8"	\$ 40.58
731-2	3"	3"	35.88

**BALL
FINIAL**

112 for 1-1/2" rail.
2 for 2" rail.

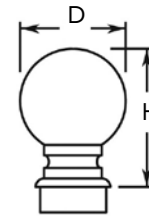

Code	D	H	List/ea
604-112	2-5/8"	3-1/4"	\$ 44.21
604-2	3-1/8"	4-1/2"	52.57

**FLUSH 135°
ANGLE**

112 for
1-1/2" rail.

2 for 2" rail.

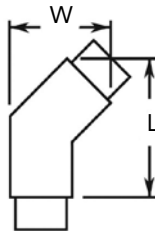

Code	W	L	List/ea
730-112	2-3/8"	3"	\$ 23.31
730-2	2-7/8"	3-3/8"	53.26

**WALL
FLANGE**

112 for 1-1/2" rail.
2 for 2" rail.

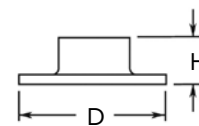

Code	D	H	List/ea
510-112	3"	1-1/4"	\$ 17.53
530-2	4"	1-1/4"	28.58

FLUSH END CAP

112 for
1-1/2" rail.

2 for 2" rail.

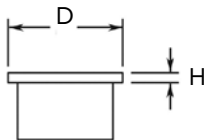

Code	D	H	List/ea
600-112	1-1/2"	1/8"	\$ 6.13
600-2	2"	1/8"	12.58

**FLOOR
FLANGE**

112 for 1-1/2" rail.
2 for 2" rail.

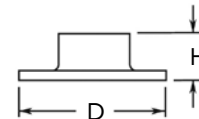

Code	D	H	List/ea
512-112	4"	1-1/4"	\$ 25.65
532-2	5"	1-3/8"	32.55

MACK WALLBEDS



The MACK EUROBED™ is a fully adjustable progressive tensioning bed mechanism. Commercial quality. Frames are shipped fully assembled so minimal shop time is required. Easy to install - all installation hardware is included.

All frames are shipped with a fine quality innerspring mattress designed to meet weight specifications of the bed frame, mattress & bedface when installed. Mattress rests on steam-bent, laminated birch slats. The slats offer more support than a box spring and are just as comfortable. You can leave your sheets, blankets and pillows on the bed when you close it.

Sizes available: Twin, Twin X-long, Full, Full X-long and Queen.

Frame colors available: Black (BL), White (WH), Almond (AL), and Terra Cotta (TC). All with matching vinyl pillow pad.

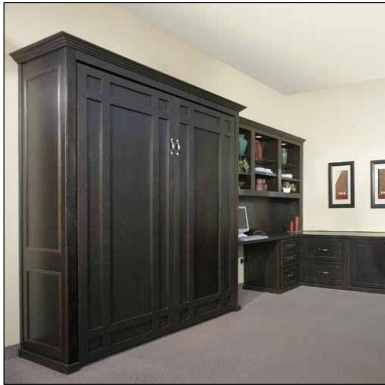

(Cabinetry not included)

12

Net Clear Opening Requirements (Recess Depth is Minimal at 18-5/8")

<u>Code</u>	<u>Size</u>	<u>Opening Width</u>	<u>Opening Height</u>	<u>Min. Recess Depth</u>	<u>Projection from Face of Cabinetry when Open</u>	<u>List</u>
4182*	Twin	41"	78-7/8"	18-5/8"	68-3/8"	\$ 2415.00
4187*	Twin Long	41"	83-7/8"	18-5/8"	73-5/16"	2531.00
5682*	Full	56"	78-7/8"	18-5/8"	68-3/8"	2531.00
5687*	Full Long	56"	83-7/8"	18-5/8"	73-5/16"	2722.00
6387*	Queen	62-1/2"	83-7/8"	18-5/8"	73-5/16"	2722.00

Upgrade to Royal Plush Mattress: add \$ 200 List
 Upgrade to Tempersselect Mattress: add \$ 933 List

Indicate Frame Color: BL, WH, AL or TC

* Special Order. F.O.B. Petaluma, CA. Most items 1 to 3 week lead time. (Twin Long, Full Long and black frames 3 to 6 weeks.) Construction video tape and shop site demos available.