

°eluma LED Shelving Quote & Order Form

Request for: Quote Order

Company: _____
 Contact Name: _____
 Address: _____
 City, State, Zip: _____
 Phone #: _____
 Fax #: _____
 Email: _____

Email (or fax) form to your authorized distributor:

Distributor Name: _____
 Branch Location: _____
 Email/ Fax: _____



Ph: (877)332-3396 Fx: (704)332-3267
 www.element-designs.com orders@element-designs.com

Date: _____ PO #: _____

① **Profile Type:** EL001 EL002

② **Profile Finish:** (select one)
 Anodized Aluminum Natural Aluminum Brushed Stainless Steel Look

Powder Coat: Oil Rubbed Bronze Black White

③ **Glass Insert Pattern:** (select one) 1/4" etched lines @ 1/4" spacing 1/16" etched lines @ 1/4" spacing Linear etch

Weight capacity for glass shelves = 75 lbs per SF. Glass may contain minor imperfections which are inherent to the mfg process.

④ **LED Color Temperature:** (select one) Warm - 3500K (Ambient Light) Daylight - 6500K (Natural Light) RGB Color Changing LED (includes RGB programmable controller)

All LED options have 50K hour useful life

⑤ **Transformers:**

QTY: _____ DC-ELT18-CON: 12V DC 18W max. - 6 LF of LED Panels

QTY: _____ DC-ELT60-CON: 12V DC 60W max. - 20 LF of LED Panels

⑥ **Wiring Components:**

OPTION A: Fixed Shelf/ Panel OR **OPTION B: Adjustable Shelf**

QTY: _____ LED-PKT-2M: 2m (79") power lead for direct wiring of panel **(1 REQUIRED per panel for all fixed applications)**

QTY: _____ MAG-TR-1M: 1m (39 3/8") power bar track **(1 REQUIRED per cabinet)**

QTY: _____ MAG-ADPRCA-NI: RCA Magnetic adapter **(1 per shelf)**

QTY: _____ EXT-2M: 2m (79") extension wire to LED-PKT-2M (optional)

QTY: _____ EXT-2M: 2M (79") extension b/w power bar & transformer **(1 REQUIRED per power bar)**

⑦ **Optional Components: Dimmers/ On-Off Switches:**

QTY: _____ DIMMER-12V: Remote control/ for up to 96W of LEDs

QTY: _____ RDSW-2M-WH: white round rocker switch w/ 2m (79") lead

QTY: _____ RDSW-2M-BL: black round rocker switch w/ 2m (79") lead

Wall Mounting Hardware Kit: for use with EL002 only

QTY: _____ EL-CSB-A (aluminum)

QTY: _____ EL-CSB-B (black)

Item	Qty	Width	*Depth/ Height	in./ mm	Exit Wire Options <small>Wire Exit Locations: Front/Bottom or Back/ Top AND Left/ Right Wire Length: 3" Standard, 20" Max.* *Back/Top exit, subtract depth dimension from max. available wire exit length</small>	Element Designs Use Only	
						Price	Ext. Price
Ex.	3	29 5/16"	11 1/2"	in.	Back - Right - 3"		
1							
2							
3							
4							

* subtract 1/2" from shelf depth in adjustable shelf applications for power bar track
 * subtract 1/4" from shelf depth in fixed shelf applications

Notes: _____

Transformers		
Other Components		
Subtotal		
Shipping		
Total		

°eluma application specifications

for additional information or customer support please call: (877) 332-3396

Exit Wire Options (choose one)

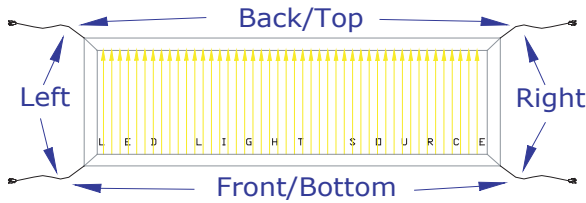

Choose exit wire location (must be a corner)

Specify exit wire (pigtail) length: Std.3", *Max.20"

*Back/Top wire exit (opposite LEDs), subtract shelf/panel depth dimension from 20" maximum available wire exit length.

(Example: 12" shelf/panel depth will have 8" available wire exit length)

Fixed Shelving (Direct Wiring: **OPTION A**)

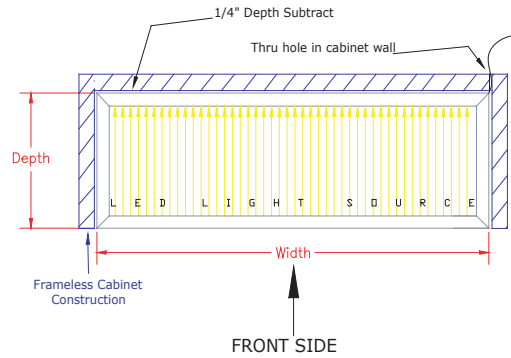

Adjustable Shelving (**OPTION B**)

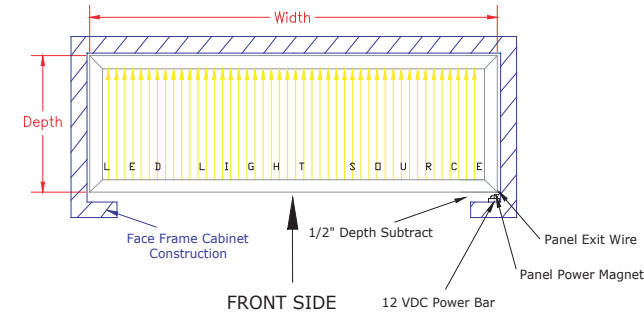

Backsplash Panel (Direct Wiring: **OPTION A**)

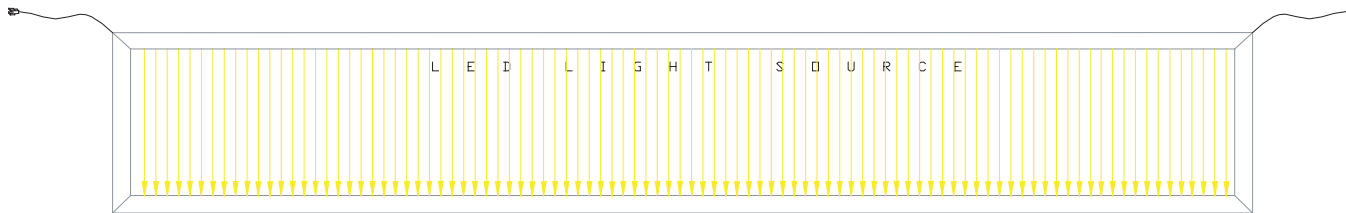

If overall backsplash width/length is greater than 60", two exit wires are required on the illuminated backsplash.

White backsplash acrylic backer panel included to eliminate transparency through illuminated backsplash.

Attachment of backsplash to wall is the responsibility of the installer.
(recommended backsplash installation methods are mounting bracket, screw to wall, or adhesive)

Wall Mount Shelving (**OPTION A or B**)

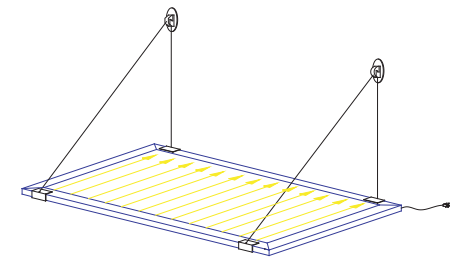

Wall Mount Shelving can be direct wire or adjustable.

Electrical Components

°eluma Panel



Fixed Shelf/
Panel Components:
(OPTION A)

OR

Adjustable Shelf/
Panel Components:
(OPTION B)



On-Off Switch Components:
(OPTIONAL)



Power Components:
(REQUIRED - CHOOSE 1)

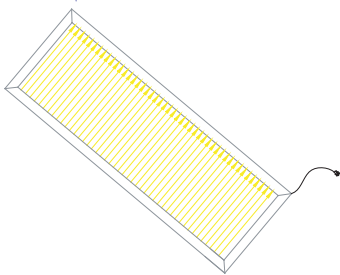

(REQUIRED)

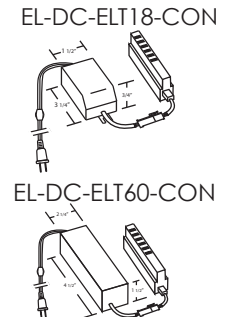
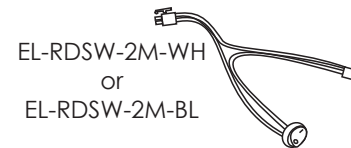
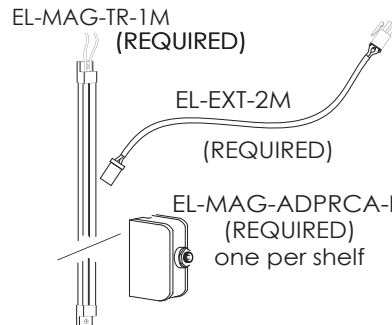
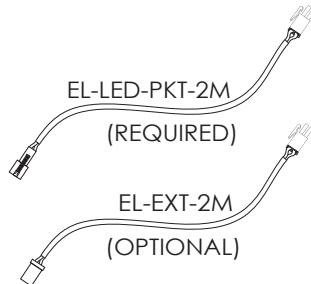

Technical specifications are subject to change without notice